

Laurel Way SOUTHMEAD

APPROXIMATE FLOOR AREA
90 SQM / 966 SQFT

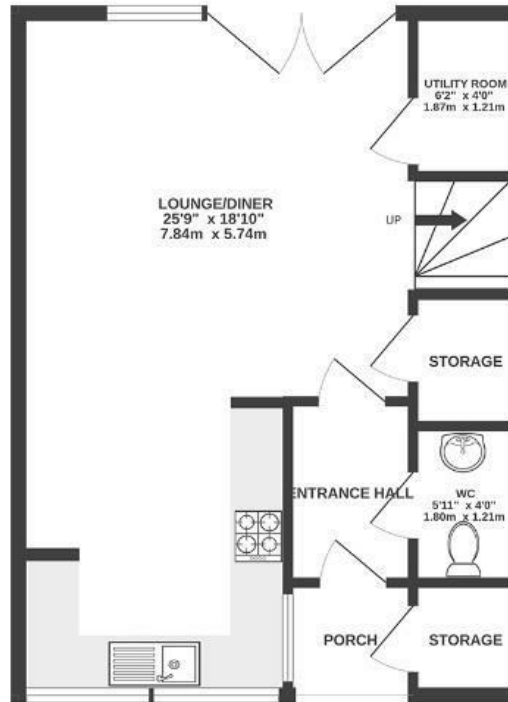

GROUND FLOOR
482 sq.ft. (44.8 sq.m.) approx.



1ST FLOOR
484 sq.ft. (45.0 sq.m.) approx.

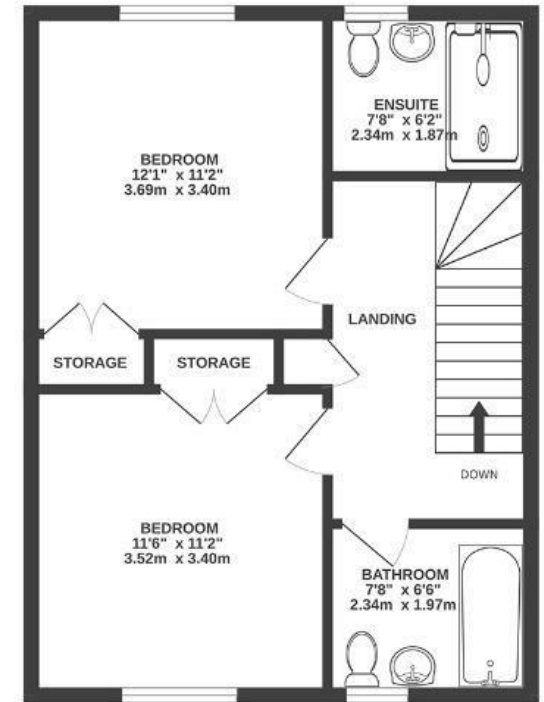

Boardwalk

Laurel Way

, BRISTOL



£340,000



2 Bedrooms



BS10 6FW



2 Bathrooms

"This well designed, award winning scheme is a real hidden gem and this house is up for sale for the first time"

